

ENGLISH

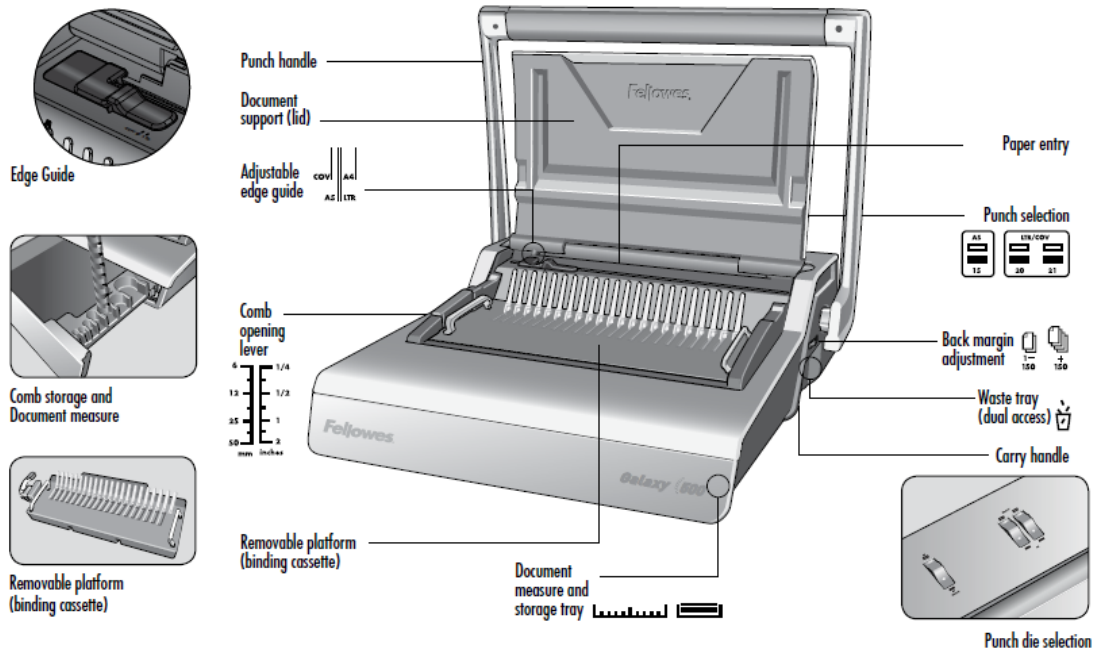

CAPABILITIES

Punching Capacity

Paper sheets	
80g / 20lb	28 sheet
Transparent Covers	
100-200 micron / 4-8 mil	4 sheet
200+ micron / 8+ mil	3 sheet
Other Standard Covers	
160-270g / 40-60lb	4 sheet
270+g / 60+ lb	3 sheet
Binding Capacity	
Max comb size	51mm
Max document (80g / 20lb)	500 sheet

Technical Data

Paper dimensions	A4
Punching slots	21
Releasable dies	3 dies (15, 20, 21)
Adjustable back margin (min = 2.5mm, max = 4.5mm)	yes - 2 positions
Slot pitch	14.28mm / $\frac{9}{16}$ "
Adjustable edge guide	yes
Waste tray capacity	3000 sheets
Net weight	10.5 kg / 23.2 lb
Dimensions (WxDxH)	450 x 530 x 165mm / 17.7" x 20.9" x 6.5"

IMPORTANT SAFETY INSTRUCTIONS — Read Before Using!

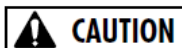

CAUTION

Please read before use. Please keep for future reference

When punching;

- always ensure the machine is on a stable surface
- test punch scrap sheets and set the machine before punching final documents
- remove staples and other metal articles prior to punching
- never exceed the machines quoted performance

When binding;



- the removable binding platform can be used away from the punch unit
- always ensure the removable binding platform is on a stable surface

Keep the machine away from heat and water sources.

Never attempt to open or otherwise repair the machine.

COMB DIAMETER & DOCUMENT SIZES

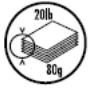
Comb diameter sizes & margin depth adjustments

			Set back margin
mm	inch	number of sheets	
6mm	1/4"	2-20	 1-150
8mm	5/16"	21-40	
10mm	3/8"	41-55	
12mm	1/2"	56-90	
16mm	5/8"	91-120	
19mm	3/4"	121-150	 +150
22mm	7/8"	151-180	
25mm	1"	181-200	
32mm	1 1/4"	201-240	
38mm	1 1/2"	241-340	
45mm	1 3/4"	341-410	
51mm	2"	411-500	

Need Help?

Customer Service . . . www.fellowes.com
Let our experts help you with a solution.
Always call Fellowes before contacting your
place of purchase.

SET UP



1. Ensure the machine is on a stable surface.

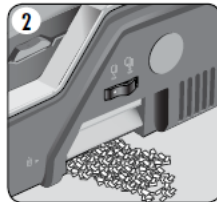

2. Check waste tray is empty and correctly fitted. The tray can be accessed from the left and right sides. The tray has a 'burst feature' that operates when the chip tray is 'over-full'.

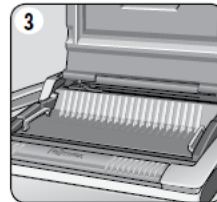

3. Ensure the binding platform is located correctly in the machine.

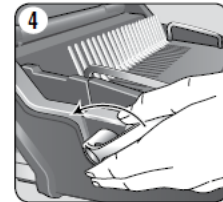

4. Ensure the comb-opening lever is pushed backwards.